

DC
15

dyson

מגניטון דיסון
החדש
הוא עוצר אבק
ועוצר שיעול

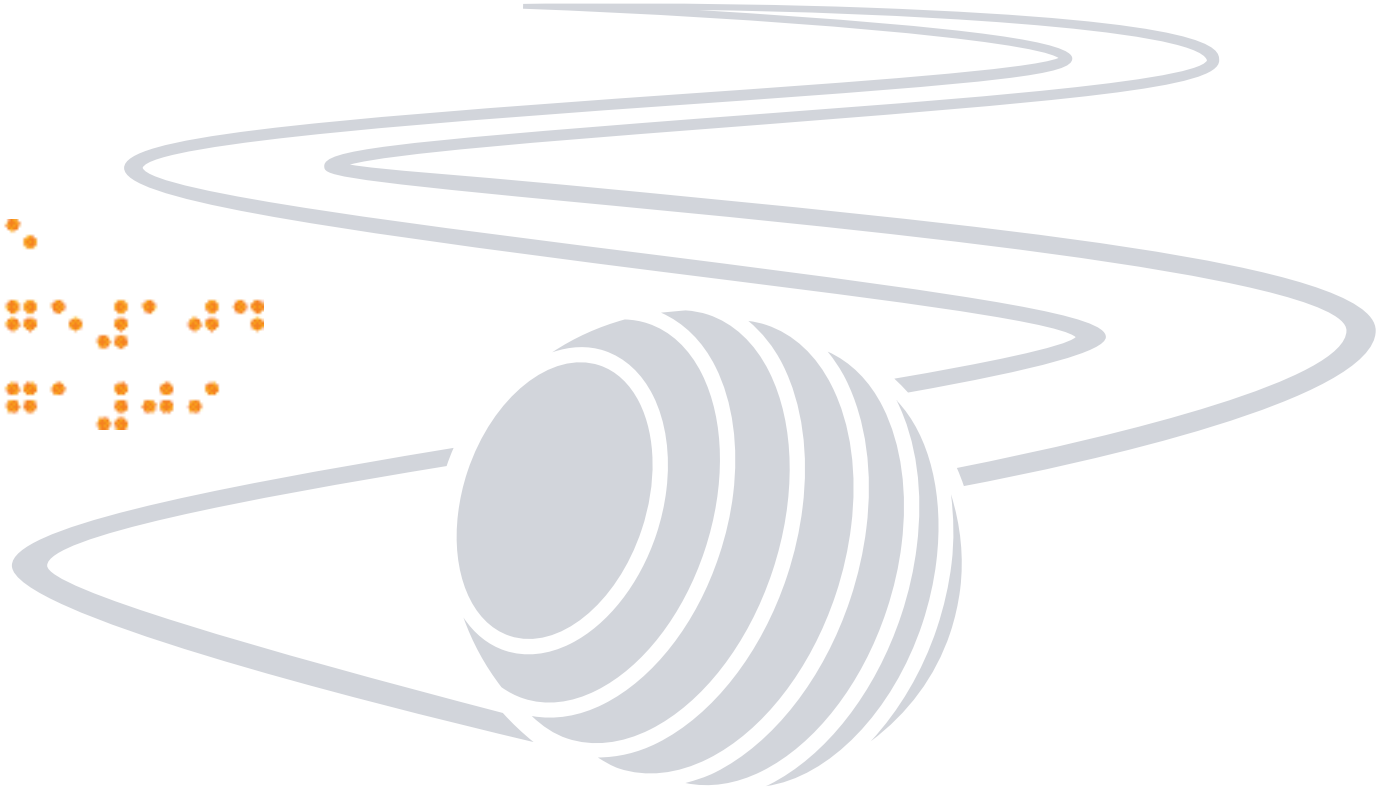

the ball User Guide

Please read this guide carefully before using your DC15

1 Assembling

! IMPORTANT

- Ensure hose is straight when inserting wand.
- Please see back of manual for optional accessories.
- If you have any questions, please call the Dyson Helpline, or log onto www.dyson.com

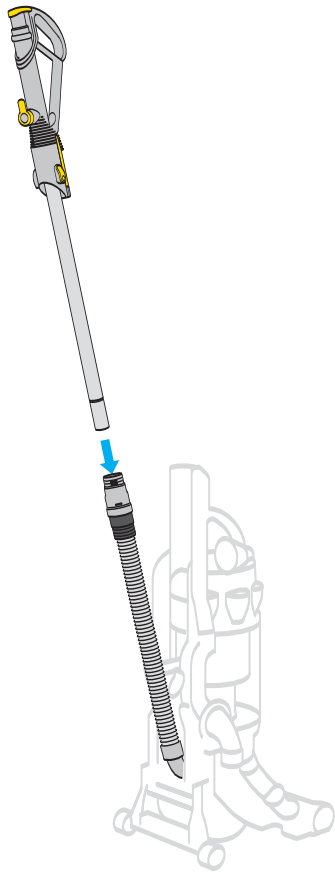

Slide wand down inside hose until it clicks.

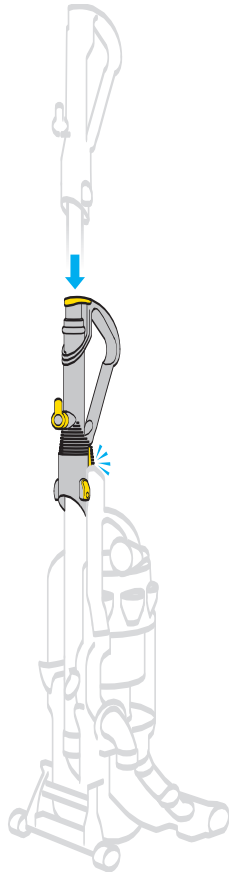

Slot wand into top of machine and click into place.

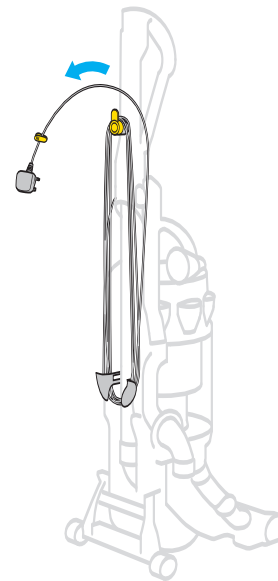

Wind cable anti-clockwise and secure with clip.

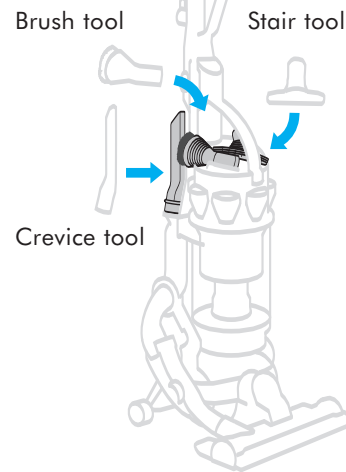

Click tools into place.

2 Using your Dyson

⚠ IMPORTANT

- Please note: this machine is intended for domestic use only. Fine dust such as plaster dust or flour should only be vacuumed in very small amounts.
- The brushbar will automatically stop if it becomes obstructed.
- Do not press the cyclone release button while carrying the machine or it could fall and cause injury.
- Ensure the cyclone is secured to the machine.
- Do not shake the machine while carrying or it could fall and cause injury.

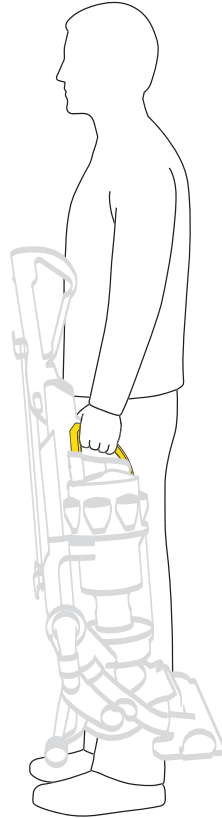

Carrying your Dyson

Ensure machine is upright before carrying.

Use the carry handle at the top of the cyclone to lift.

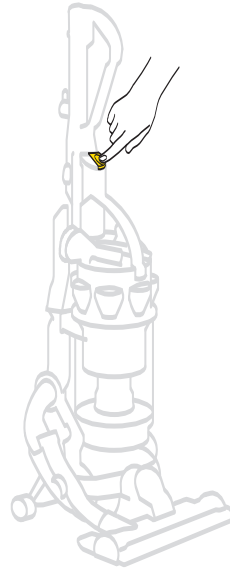
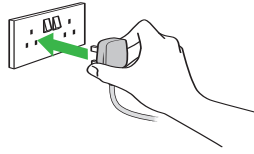

Using your Dyson

Plug in and press **ON/OFF** switch.

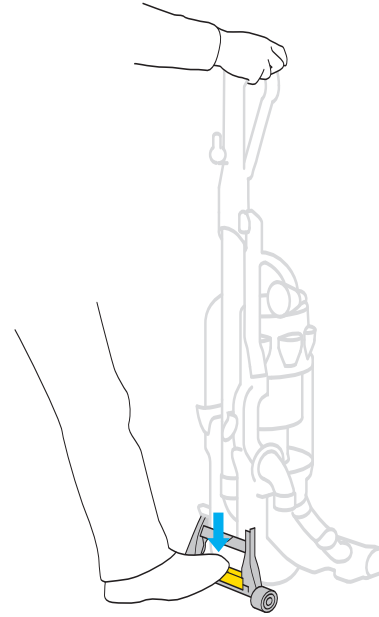

Press pedal to release cleaner head and pull handle towards you.

⚠ Use pedal only – do not stand directly on cleaner head.

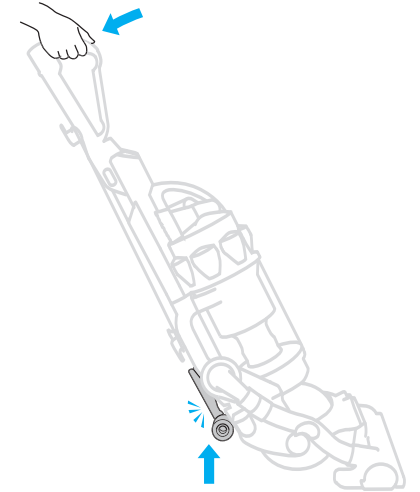

Ensure stabilising wheels are fully retracted or brushbar will not operate.

3 Using your Dyson

IMPORTANT

- The brushbar will be set to the **ON** position every time you start the vacuum.
- If the brushbar stops during use, please refer to the blockages section.
- Ensure stabilising wheels are fully locked in place when cleaner is upright before letting go of the cleaner.
- Do not run over the supply cable.

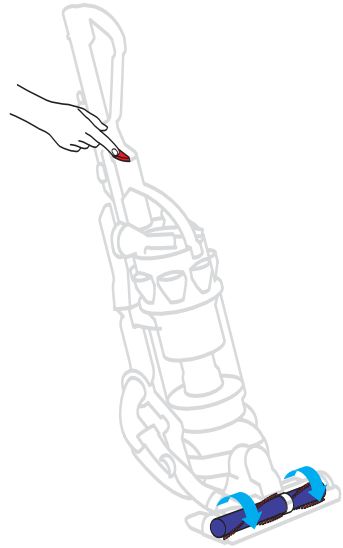

Brush control

Press button to turn brushbar **OFF** for delicate rugs, looped carpets and hard floors. Press again to restart for carpets.

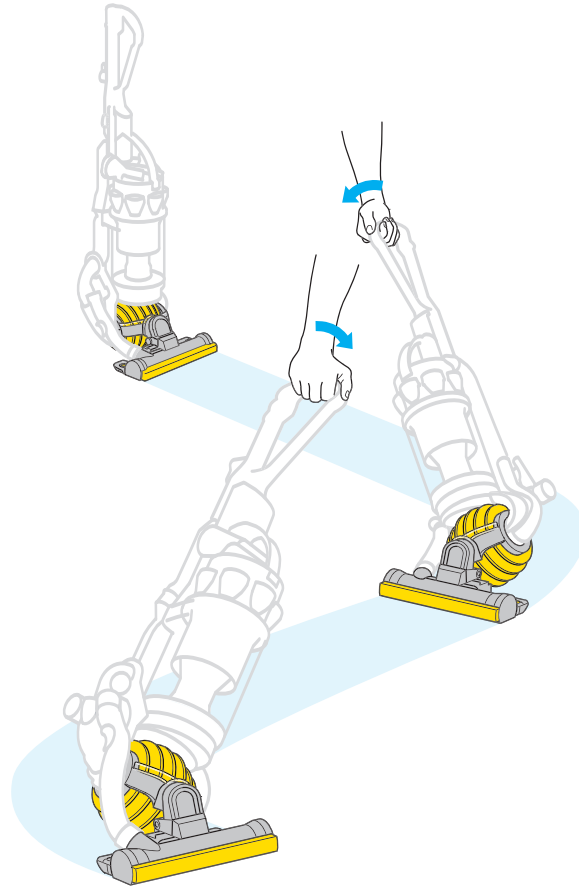

Using DC15

Small movements of the wrist will create a zigzag motion in the cleaner head, for easier cleaning around furniture.

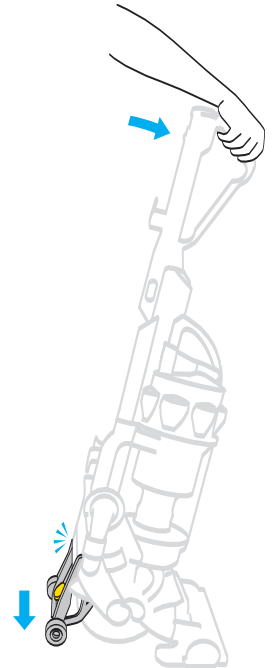

When finished, push the handle firmly beyond the upright position to drop stabilising wheels.

 *Ensure stabilising wheels are fully locked in place before letting go of the cleaner.*

4 Using the tools

! IMPORTANT

- Ensure machine is in upright position before using tools.
- To protect your floors, the brushbar will not rotate when the machine is in an upright position.
- Ensure hair and loose clothing are kept clear of wand cap when machine is switched on.
- Ensure wand cap is closed, unless using with tools.
- Powerful suction can cause the hose to 'pull back'. Please take care when cleaning stairs.

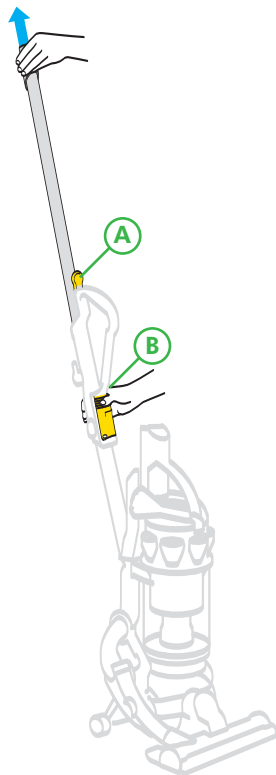

Wand mode

- A** Lift up wand cap and pull metal wand from inside handle until it clicks.
- B** Press button to release hose and wand handle from machine. To push wand back inside hose, ensure hose is straight. Press wand release button and push wand down into hose.

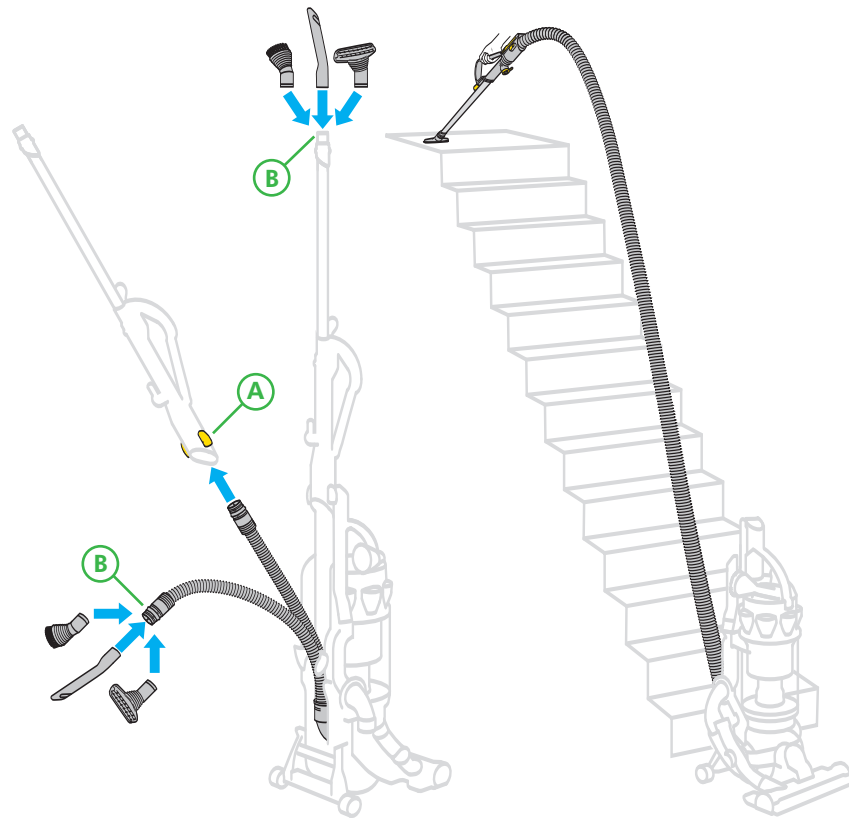

Hose mode

- A** First extend the wand, then press side buttons to remove wand handle from hose.
- B** Tools can be fitted directly to the end of hose or wand.

Stair cleaning

Always work with the machine at the bottom of the stairs.

5 Washing your filter

⚠ IMPORTANT

- Check your filter regularly and wash at least every six months.
- The filter may require more frequent washing if vacuuming fine dust.

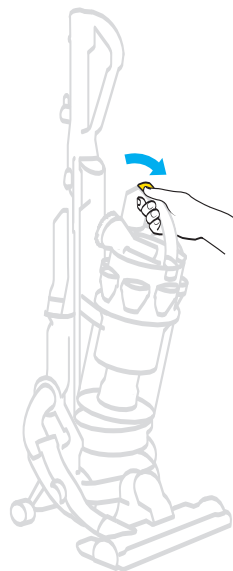
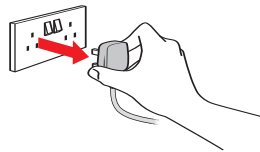
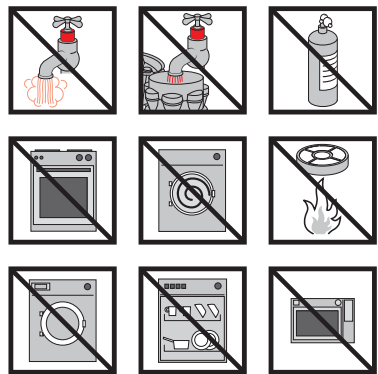

Remove cyclone from machine.

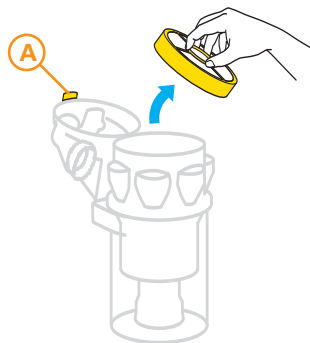

Lift filter release catch **A** and remove filter.

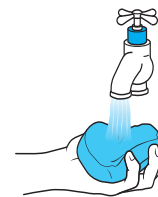

Separate blue filter and yellow case.

Wash filter and case in cold water only. Repeat until water runs clear.

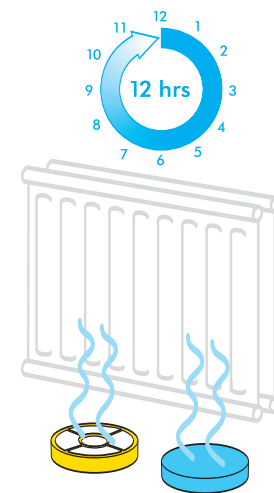

Dry for at least 12 hours. Ensure filter is completely dry before refitting onto the machine.

6 Emptying the Clear bin™

! IMPORTANT

- Do not use the machine without the clear bin™ in place.



The British Allergy Foundation considers that this product may in proper use reduce exposure to both House Dust Mite (Der p 1) and Cat Allergen (Fel d 1). It is strongly recommended that a sensitive person should take care when emptying the clear bin. We recommend the manufacturer's emptying instructions should be strictly followed.

The British Allergy Foundation is a UK national charity (Charity Re. No. 1003726) founded in 1991 with the aim of improving awareness, prevention and treatment of allergies.

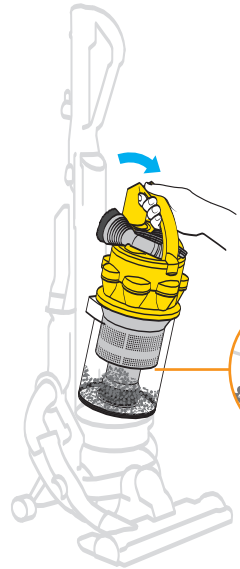
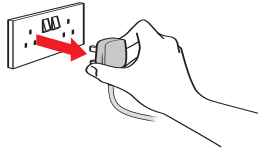

Empty bin as soon as the **MAX** mark is reached.

Press catch to release cyclone and bin from the machine.



Option 1

Push the button as shown to empty directly into dustbin.

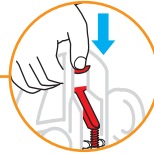

Option 2

Emptying in a bag is recommended for allergy sufferers.

Place bin in bag and push button.

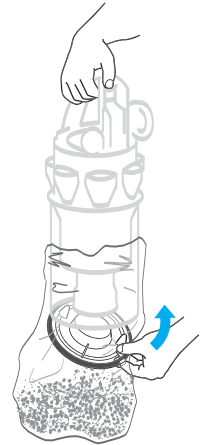

Let the dust settle and close bin base securely before removing from bag and refitting the bin on the machine.

Recommended for asthma/allergy sufferers

7 Cleaning the Clear bin™

⚠ IMPORTANT

- Do not use detergents, polishes or freshening products.
- Do not immerse the whole cyclone in water.
- Ensure parts are completely dry before replacing.

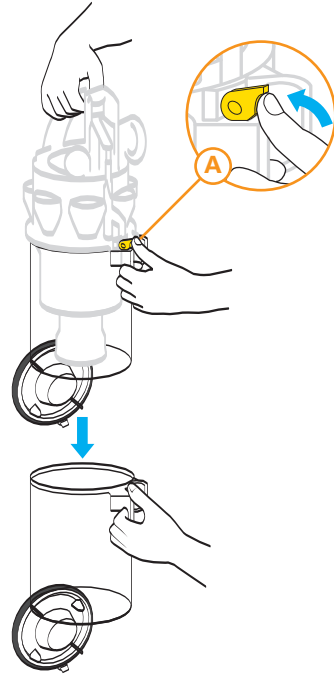
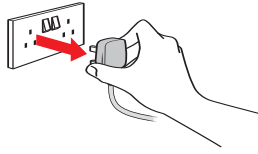

Cleaning the shroud *(optional)*

Ensure bin is empty and bin base is open.

A Press catch to release the clear bin™ from the cyclone.

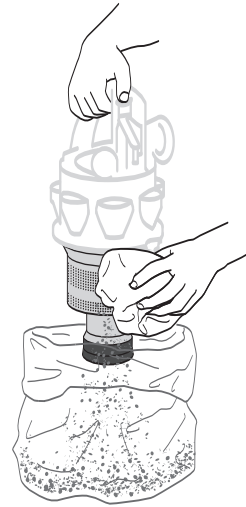

Clean shroud with a cloth or dry brush to remove fluff.

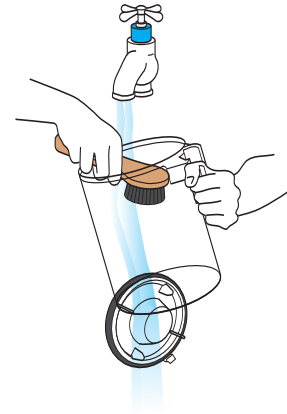

Cleaning the Clear bin™ *(optional)*

Ensure bin is empty and bin base is open.

Rinse with cold water only.

Ensure bin is dry before replacing.

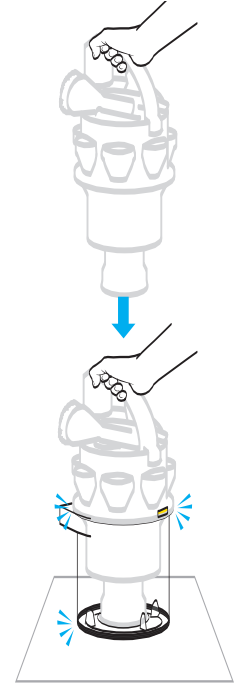

Re-assembling the Clear bin™

Holding carry handle, fit cyclone inside the clear bin™.

Line up the front and rear guides and push down to secure.

8 Clearing blockages

! IMPORTANT

- If any part of the machine becomes blocked, it may overheat and then automatically shut off. Unplug machine and leave to cool down.
- For safety, please lay the machine on its side before checking for blockages.
- Refit all parts of the machine securely before using it.
- Beware of sharp objects when clearing blockages.

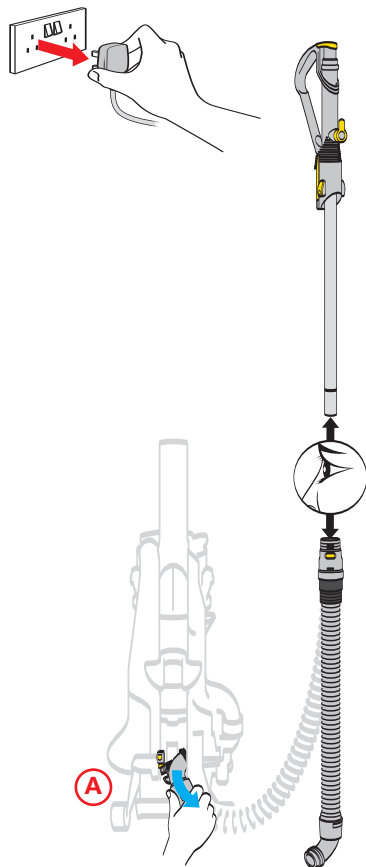

Check tools, wand and hose are clear of blockages.

A To remove the hose, rotate base of hose downwards until it clicks, then twist away from the machine.

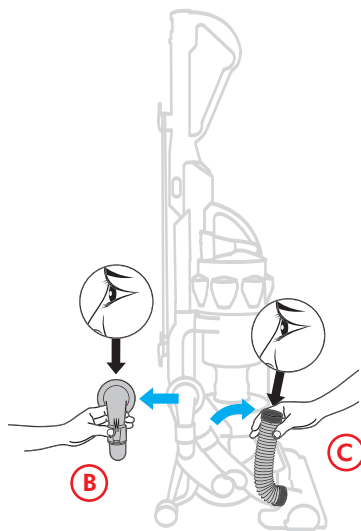

B Squeeze release catches to remove the airway inspection and check inside.

C Pull the top end of the tube away from machine and check inside.

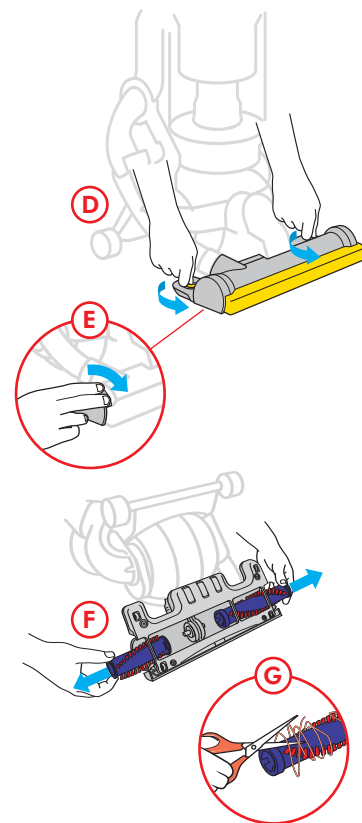

D Undo coloured soleplate fasteners with a coin.

E Rotate endcaps to remove.

F Pull out brushbar sections.

G Cut out debris avoiding bristles.

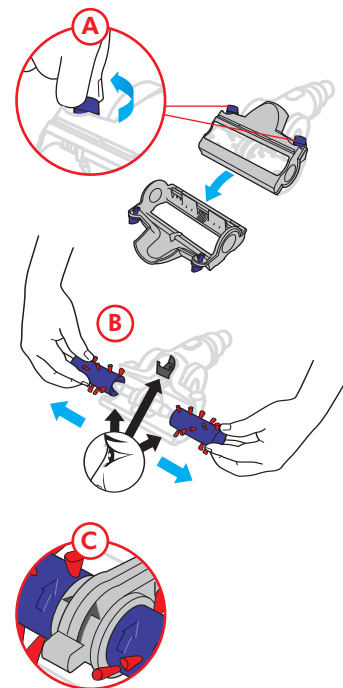

Maintaining mini turbine head*
(Supplied with certain models or available as an accessory).

A Undo fasteners and remove soleplate.

B Remove brushbars and debris. When re-assembling, ensure brushbar arrows match those on central support **C**.

*Selected models only.

DC15 accessories

These items can be used with your DC15. For further information visit the Dyson website www.dyson.com



Hard floor tool

For improved pick-up on hard floors.



Stubborn dirt brush

With stiff bristles for dried-in and stubborn dirt.



Flexi crevice tool

Extends and flexes into awkward gaps.



Soft dusting brush

Soft bristles to gently dust around the home.



Mattress tool

Removes dirt and dust mites from mattresses and upholstery.



Car turbine head

Cleans pet hair and fibres from confined spaces.



Mini turbine head

Picks up pet hair and dirt from stairs and upholstery.



Low reach floor tool

For easier cleaning under low furniture.



Carpet cleaning kit

Keeps new carpets looking new.

! Important safety information

Take care to ensure objects or body parts are not inserted into the cleaner head

1. This appliance is not intended for use by young children or infirm persons without supervision. Young children should be supervised to ensure they do not play with the appliance or place body parts near the cleaner head.

2. The plug must be removed from the socket outlet before cleaning or maintaining the appliance.

3. Check to ensure your electricity supply corresponds to that shown on the rating plate, which can be found behind the clear bin™. The machine must only be used as rated.

4. If the supply cable of the cleaner is damaged, disconnect from the socket immediately. The cable must be replaced by Dyson Ltd. or our appointed agent to avoid a hazard.

5. Do not use the cleaner if the cable or plug are damaged or if the cleaner has been damaged, dropped or has come in to contact with water or any other liquid. In these cases, contact the Dyson Helpline.

6. When vacuuming, certain carpets may generate small static charges in the clear bin™. These are entirely harmless and not associated with the power supply. To minimise any effect from this, do not insert hand or any object into the clear bin™ unless you have first emptied it and rinsed it with cold water.

7. Do not use the cleaner if any parts appear to be faulty, missing or damaged.

8. Do not carry out any maintenance work other than that shown in this manual or advised by the Dyson Helpline, and do not put anything into the openings or moving parts of the machine.

9. Only use parts recommended by Dyson; failure to do so could invalidate your guarantee.

10. If you have a query about your Dyson, call the Dyson Helpline with your serial number, which can be found behind the clear bin™.

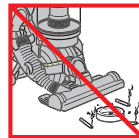
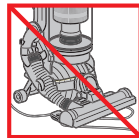
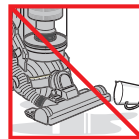
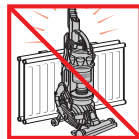
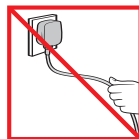
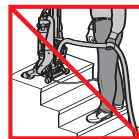
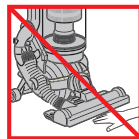

DC15 List of patent and patent applications

GB 2407784 A	CA 2,438,073	AU 2002283157	MY 20053364
AU 2005266174	EP1371197	CA 2,495,053	NZ 502140
CA 2,375,456	JP2004-500138	EP1520794	RU 2007169091
CN 20058025372.9	US 6,991,666	JP 2004/526998	TW 94124788
EP 1786568	AU2002252322	US 2005-023544	US 11,632,851
IN 252,802A/2007	CA 2,438,079	AU 20020383199	AU 2005263889
KR 10-2007-7002254	EP1361815	CA 2,495,066	CA 2,572,834
MY 20053420	JP 2004-520139	EP 1526797	EP 1768536
NZ 502921	US 6,974,488	JP 2004-526999	MY 20053366
RU 2007107593	GB 2404887 A	US 2005-0223514	US 11,631,109
TW 94125514	AU 2004854703	AU 2002283161	AU 2005244378
AU 2004296771	CA 2,538,344	CA 2,495,072	CA 2,567,214
CA 2,544,609	CN 20048022734.4	EP1526798	CN 200580015099.1
CN 2004803031.447	EP 1635837	JP 2004-527000	EP 1748717
EP 1680252	JP 2006-322414	US 10,925,046	JP 2007-510097
HK 06112477.1	US 10,565,947	AU 2005263890	MY 20052008
IN 1997/04LN/2006	AU2002252507	CA 2,574,689	US 11,996,321
JP 2006-304152	CA 2,438,069	EP 1748537	AU200233553
KR 10-2006-7006143	EP1361814	IN 423/KOLN/2007	CA 2,439,247
MY 20044301	US 7018439	KR 10-2007-7000619	EP 1365676
NZ 546986	JP 3805541	MY 20053365	EP 2004-524097 A
RU 2006120054	AU2001240894	US 5521,611	US 2004-0078925 A
TW 93132704	EP1268076	RU 2007106708	AU200325873
US 6,974,263	JP2003-208704 A	US 6,974,263	CA 2,445,924
AU200226556	US 6,855,222	US 11,632,851	EP1380247
CA 2,439,250	AU 63772	AU 2005263897	JP 2003-344965
EP 1370137	CA 2,056,161	CA 2,574,291	US 2004-011828 A
JP 2004-528876	EP 0436338	EP 1771104	
US 2004/074219 A1	EP148863	IN 422/KOLN/2007	
AU2002252509	US 6,976,761	KR 10-2006-7007655	

Registered designs and applications

GB 302039	GB 303040	GB 303041	ED 000281191-0001
AU 303455	AU 303544	AU 303556	AU 303558
ZL 200530117166.3	ZL 200530117096.1	ZL 200530139935.8	ZL 200530139935.8
E 40941	E 40949	E 40960	E 40969
US 29/234433	USD 532149	USD 534324	

5 year guarantee

Register now for your free 5 year guarantee



ONLINE

Just visit

www.dyson.co.uk/register



PHONE

7 days a week

(UK) 0800 298 0298
(IRL) (01) 475 7109



MAIL

Complete and return the
freepost registration form

ask dyson
advice & support

We'll help you choose the right Dyson cleaner and give you any advice and assistance you need when you're using it. You can contact us anytime at www.dyson.com or call our team of experts on UK 0800 298 0298, IRL 01 475 7109 between 7am and 10pm, 7 days a week.

www.dyson.com

Ensure you register for your 5 year guarantee today

After registering for your 5 year guarantee, your Dyson vacuum cleaner will be covered for parts and labour for 5 years from the date of purchase, subject to the term of the guarantee.

If you have any query about your Dyson, call the Dyson Customer Helpline with your serial number and details of where/when you bought the cleaner. Your serial number can be found on your rating plate which is behind the clear bin™.

Most queries can be solved over the phone by one of our trained Helpline staff. If your machine needs attention, we'll aim to send one of our Dyson engineers to fix it within 3 working days. We won't keep you waiting around either: our engineers can visit a home or work address - wherever is most convenient for you.



Note your serial number for future reference: